USER MANUAL

**MODEL NUMBER:
5LSP**

1.3 gallon (5 liter) Pump-Up Spray Unit

English (Original Instructions)

READ ALL INSTRUCTIONS BEFORE OPERATING EQUIPMENT



Read this manual completely and understand the machine before operating or servicing it.

- Read all instructions before installing or operating unit.
- Always wear appropriate personal protective equipment (PPE) when operating or servicing unit.
- Always follow all chemical safety precautions and handling instructions provided by the chemical manufacturer and Safety Data Sheet (SDS).
- If this unit is modified or serviced with parts not listed in this manual, the unit may not operate correctly.
- Never point the discharge wand at yourself, another person, or any object you do not want covered in chemical.
- Never leave unit unattended while pressurized.
- Always depressurize unit before attempting to remove the pump assembly.
- Always depressurize unit after use (as described in the After Use Instructions). Always store unit depressurized.
- Do not pressurize unit by any means other than the built-in pump assembly.
- Do not modify or remove pressure relief valve. Do not use unit if pressure relief valve is not operational.
- Always flush the unit with fresh water for 5 minutes when switching from an alkaline to an acid or an acid to an alkaline.
- Never use unit with hydrocarbons or flammable products.
- Do not exceed a fluid temperature of 100°F (37°C).

PROTECT THE ENVIRONMENT

Please dispose of packaging materials, old machine components, and hazardous fluids in an environmentally safe way according to local waste disposal regulations.



Always remember to recycle.

*Specifications and parts are subject to change without notice.

REQUIREMENTS	
Liquid temperature range	40-100°F (4.4-37°C)
Chemical compatibility	Chemical products used with this equipment must be formulated for this type of application and compatible with unit materials and pump seals. For more information on chemical compatibility, consult the manufacturer or SDS for your product or contact our customer service department.

SPECIFICATIONS	
Power type	Manual
Chemical pickup type	Draws from pre-mixed solution
Number of products unit can draw from	One product
Capacity	1.32 gallons (5 liters)
Discharge hose diameter/length	4 ft. (1.2 m) hose with 1/4 in. (6.35 mm) inside diameter
Discharge wand/tip type	Polypropylene trigger handle with 80° fan tip (STB8002)
Output distance	2-3 ft. (0.6-0.91 m) with fan tip
Pump seals	Viton

READ ALL INSTRUCTIONS BEFORE OPERATING EQUIPMENT

Operation Instructions:

1. Ensure all air pressure is released from unit by pulling up on the red pressure relief valve.
2. Ensure the trigger handle (PUF5L-PSG-P) is not in locked position.
3. Securely hold the unit and unscrew the pump assembly (PUF5L-PA) from the tank in a counter-clockwise motion.
4. Follow all instructions from chemical manufacturer. Fill tank 3/4 of the way with pre-mixed solution. (Note: Do not overfill tank with solution.)
5. Securely hold the tank and screw the pump assembly back on in a clockwise motion.
6. Pressurize the tank by pumping approximately 15 to 20 times, or until air pressure gauge reads 25 psi (1.7 bar). (Note: The pressure relief valve will leak if the air pressure is too high. Do not overfill tank with air)
7. Once the desired pressure has been achieved, push the handle down and twist it clockwise to lock it in place.
8. To start spraying, point the wand assembly at the area you wish to spray and squeeze the trigger handle to discharge solution.

After Use Instructions:

1. Ensure all air pressure is released from unit after each use by pulling up on the red pressure relief valve.
2. It is recommended to always empty out remaining solution and run fresh water through the unit to rinse all parts thoroughly after each use and before storage.

Maintenance Instructions:

Warning: Always depressurize unit before performing maintenance.

To keep your unit operating properly, periodically perform the following maintenance procedures:

- Check the pump assembly (PUF5L-PA) for wear and leaks.
- Check the suction tube for debris and clean as needed.
- Inspect hoses (PUF5L-HA) for leaks or excessive wear.
- Periodically lubricate the pump seal with food safe lubricants. To lubricate the pump seal, raise pump handle and apply 5 to 10 drops of food safe lubricant between pump and pump sleeve. NEVER USE LUBRICANTS SUCH AS WD40.

READ ALL INSTRUCTIONS BEFORE OPERATING EQUIPMENT

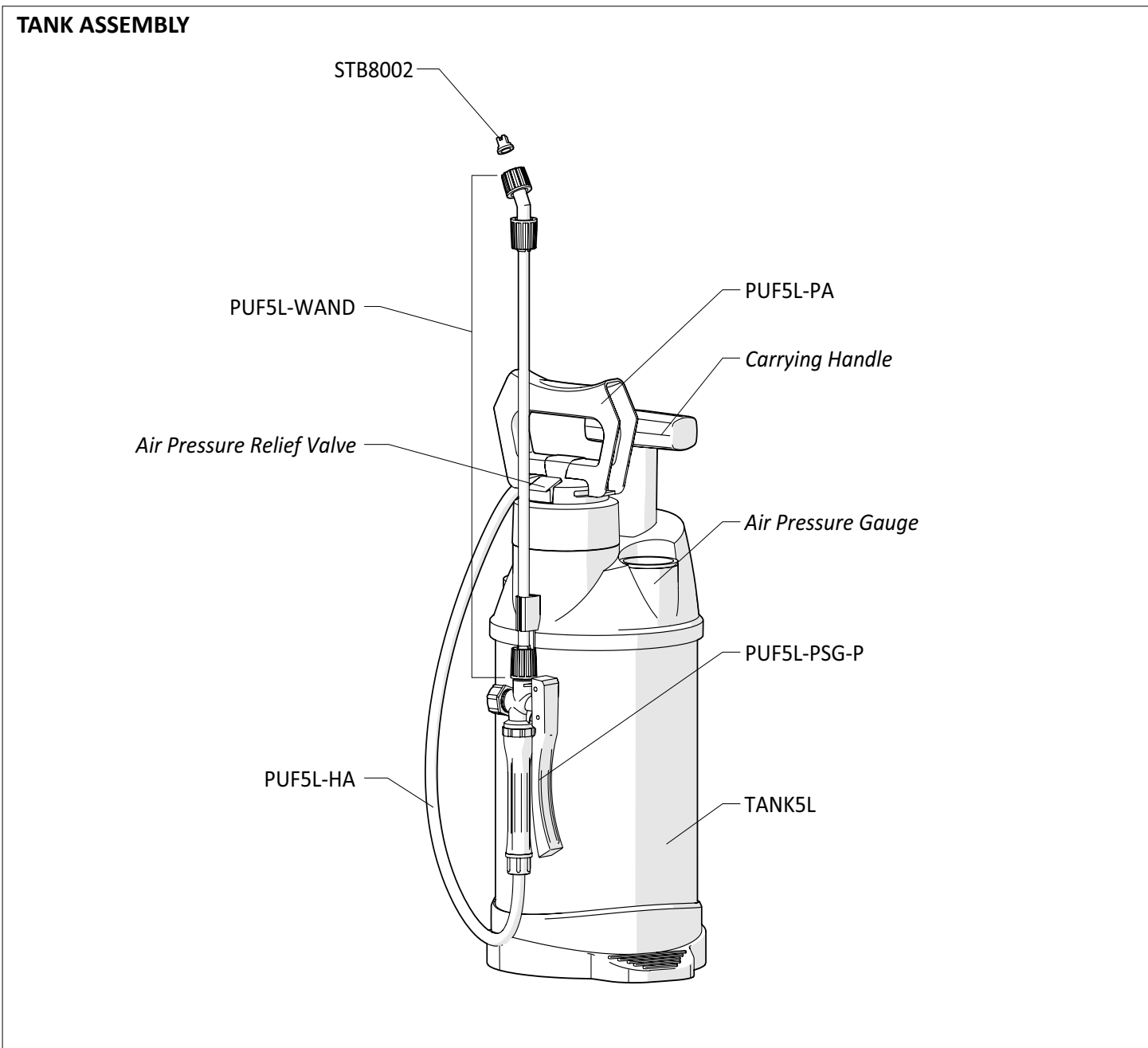

ITEM NUMBER	DESCRIPTION
PUF5L-HA	HOSE ASSEMBLY FOR 5L10X (INCLUDES SUCTION LINE)
PUF5L-PA	PUMP ASSEMBLY FOR 5L10X
PUF5L-PSG-P	SPRAY GUN ASSEMBLY FOR 5LSP

PUF5L-WAND	WAND EXTENSION FOR 5L10X
STB8002	BUTTON SPRAY TIP - FLAT FAN - 80 DEGREE 0.2 GPM
TANK5L	NATURAL 5 LITER TANK WITH PRESSURE GAUGE