USER MANUAL

MODEL NUMBER:

GK7T

GK7T-2

GK7T-3

**Twin-Line Doorway Foam Nozzle
Assembly**

English (Original Instructions)

READ ALL INSTRUCTIONS BEFORE OPERATING EQUIPMENT



WARNING



Read this manual completely and understand the machine before operating or servicing it.

- Read all instructions before installing or operating unit.
- Always wear appropriate personal protective equipment (PPE) when operating or servicing unit.
- Always follow all chemical safety precautions and handling instructions provided by the chemical manufacturer and Safety Data Sheet (SDS).
- If this unit is modified or serviced with parts not listed in this manual, the unit may not operate correctly.
- Do not exceed an incoming air pressure of 100 psi (7 bar).
- Do not exceed a fluid temperature of 100°F (37°C).
- Always flush the unit with fresh water for 5 minutes when switching from an alkaline to an acid or an acid to an alkaline.
- Never use unit with hydrocarbons or flammable products.
- Only use clean and dry air. Air must be filtered and free of moisture or pump life will be diminished. If needed, install an air dryer before unit.
- Do not use an air lubricator before the unit.
- Never use unit if it is damaged or leaking.
- Disconnect unit from electrical power source before servicing.

READ ALL INSTRUCTIONS BEFORE OPERATING EQUIPMENT

Installation Instructions:

1. Remove all components from packaging.
2. Mount the stainless steel nozzle assembly in the desired location, using two stainless steel brackets (SSFTB) and four of the screws and plastic anchors provided in the parts package. Repeat as needed for multiple nozzles.

Note: The foam pattern dimensions provided in this manual were measured with nozzle assemblies mounted 6 in. (15 cm) above the floor.

3. Run tubing from the solution outlet fitting on the control box to the solution inlet fitting on the nozzle assembly. For multiple nozzles, run the tubing from the control box into a tee fitting (QFT12), as shown in the diagram. Then, run tubing from the tee fitting to the nozzle assemblies. For systems with three nozzles, use a second tee fitting to split the line again.
4. Run tubing from the air outlet fitting on the control box to the air inlet fitting on the nozzle assembly. For multiple nozzles, split the line using one or more tee fittings (QFT12), as described in step 6 and shown in the diagram.

Note: The air and solution lines must be routed to the appropriate fittings (as labeled), or the foam quality of the unit will be negatively impacted. Make sure to insert the tubing all the way into the fittings to ensure proper connection.

5. When running multiple tip assemblies off one control box, it is recommended to change spray nozzle based on chart specification below:

Item Number	Number of Tip Assembly	Recommended Spray Nozzle
GK7T	1	ST80200
GK7T-2	2	ST80100
GK7T-3	3	ST8060-1/2
Air operation range: 40 to 80 PSI (3 to 5 bar) with 3.5 to 8 CFM (99.15 to 226.62 l/min)		

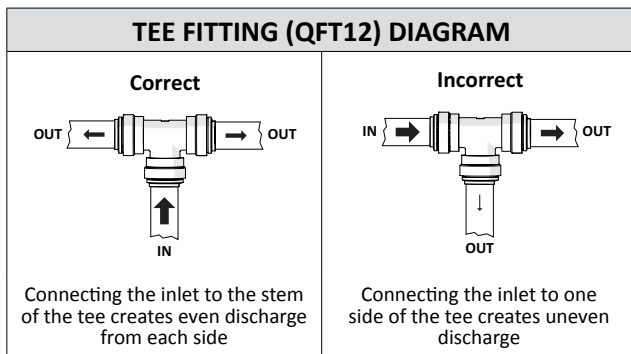

READ ALL INSTRUCTIONS BEFORE OPERATING EQUIPMENT

NOZZLE ASSEMBLY

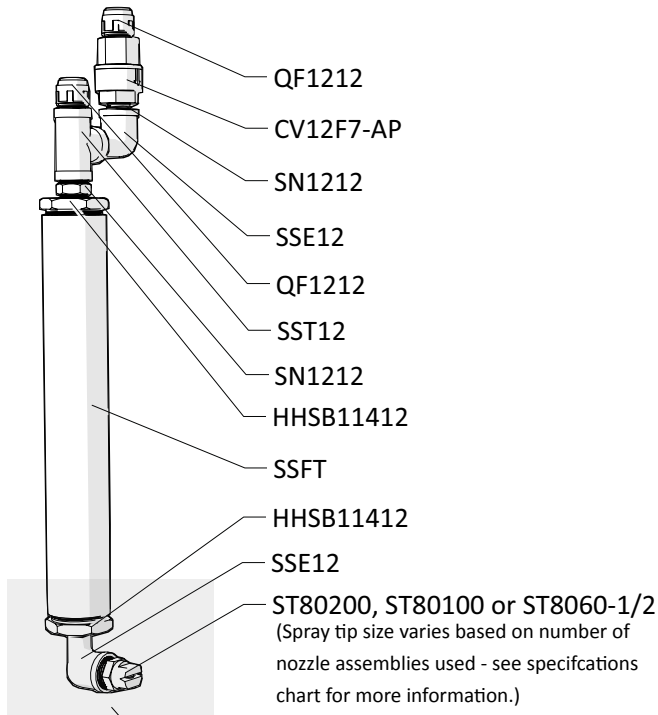

NOZZLE ASSEMBLY DETAIL

This unit includes an adjustable ball-type nozzle that may be installed to hold the spray tip as shown.

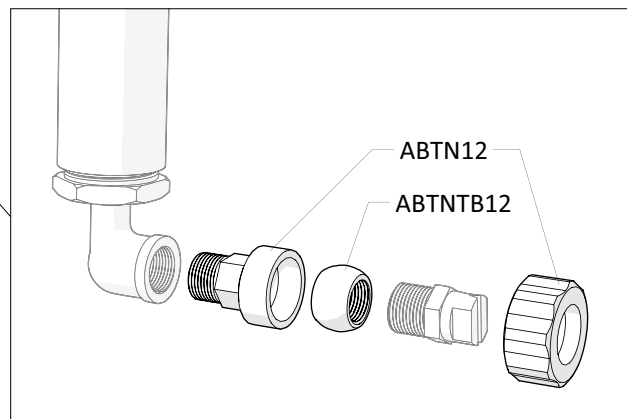

READ ALL INSTRUCTIONS BEFORE OPERATING EQUIPMENT

Parts list:

Item Number	Description
ABTN12	ADJUSTABLE BALL-TYPE NOZZLE 1/2in NPT
ABTNTB12	1/2in THREADED BALL FOR ABTN12
CV12F7-AP	1/2 CHECK VALVE 7 POUND SPRING - ACID PROOF BLK/WHT CHK 685-8F8F-E,7#H,O-RNG.
H12CP	1/2IN OD POLYTUBE NATURAL
HHSB11412	HEX HEAD STAINLESS BUSHING 1 1/4IN BY 12IN
QF1212	MALE CON. 1/2in TUBE X 1/2in MPT
QFT12	UNION TEE 1/2in TUBE
SN1212	1/2in HEX STAINLESS STEEL NIPPLE
SSE12	STREET ELBOW 1/2in - 316 S.S.
SSFT	Stainless Steel Foam Tube 1 1/2in
SSFTB	STAINLESS STEEL FOAM TUBE BRACKET
SSMESH	REPLACEMENT MESH AND SCREEN DISC FOR S.S. TWIN LINE NOZZLE ASSEMBLY
SSST	SCREEN DISC .687 DIA. 10 X 10 MESH @ .020 DIA. 300 SERIES S.S.
SST12	1/2in FPT 304 S.S. TEE
ST80100	VEEJET NOZZLE, BRASS 80100
ST80200	VEEJET NOZZLE, BRASS 80200
ST8060-1/2	VEEJET NOZZLE, BRASS 8060-1/2
WMS14	14 X 1 1/4 HEX W/H SMS SLOTT, S/S
WMS14A	5/16 X 1 1/2 STRAIGHT PLASTIC ANCHOR