READ ALL INSTRUCTIONS BEFORE OPERATING EQUIPMENT

User Manual for Models:

TS5600

TS5600V

TS5600K

|Teat Spray Unit|

READ ALL INSTRUCTIONS BEFORE OPERATING EQUIPMENT

READ ALL INSTRUCTIONS BEFORE OPERATING EQUIPMENT

Requirements:

Compressed air 40 to 80 PSI (3 to 5 bar) with 3.5 to 8 CFM (99.148 to 226.62 l/min)

Chemical requirements: follow all instructions from chemical manufacturer.

Air Operated Double Diaphragm Pump Options:

P56.....Flojet polypropylene body with Santoprene diaphragm

P56V..... Flojet polypropylene body with Viton diaphragm

P56K..... Flojet polypropylene body with Kalrez diaphragm

Acceptable Products: Alkaline cleaners, Caustic cleaners, Sanitizers, and Acids.

* D-Limonene and peracetic acid may only be used with Kalrez pump

* Chlorine may only be used with Viton or Kalrez pump

DO NOT USE: All hydrocarbons



WARNING

Avoid Personal Injury



1. Always wear protective clothing, gloves, and eye wear while operating unit.



2. Avoid contact of cleaning agent with skin and eyes. If contact occurs, see MSDS sheet for further first aid measures.



3. Follow safety instructions of chemical manufacturer (MSDS).

4. After each use, relieve all remaining pressure in the system by unplugging the air line from the unit and opening the discharge valve to prevent accidental discharge.

5. Never point the discharge at anyone.

6. After relieving the pressure from the unit, store the unit with the valve in the closed position.



CAUTION

Avoid Equipment Damage

1. Only use clean and dry air. Air must be filtered and free of moisture or pump life will be diminished. If needed, install air dryer before unit.

2. Do not use air lubricator before the unit.

3. Be sure to flush the unit with fresh water for 5 minutes when switching from an alkaline to an acid or an acid to an alkaline.

4. Do not exceed a fluid temperature of 110°F (43°C).

READ ALL INSTRUCTIONS BEFORE OPERATING EQUIPMENT

Inside View - Control Box

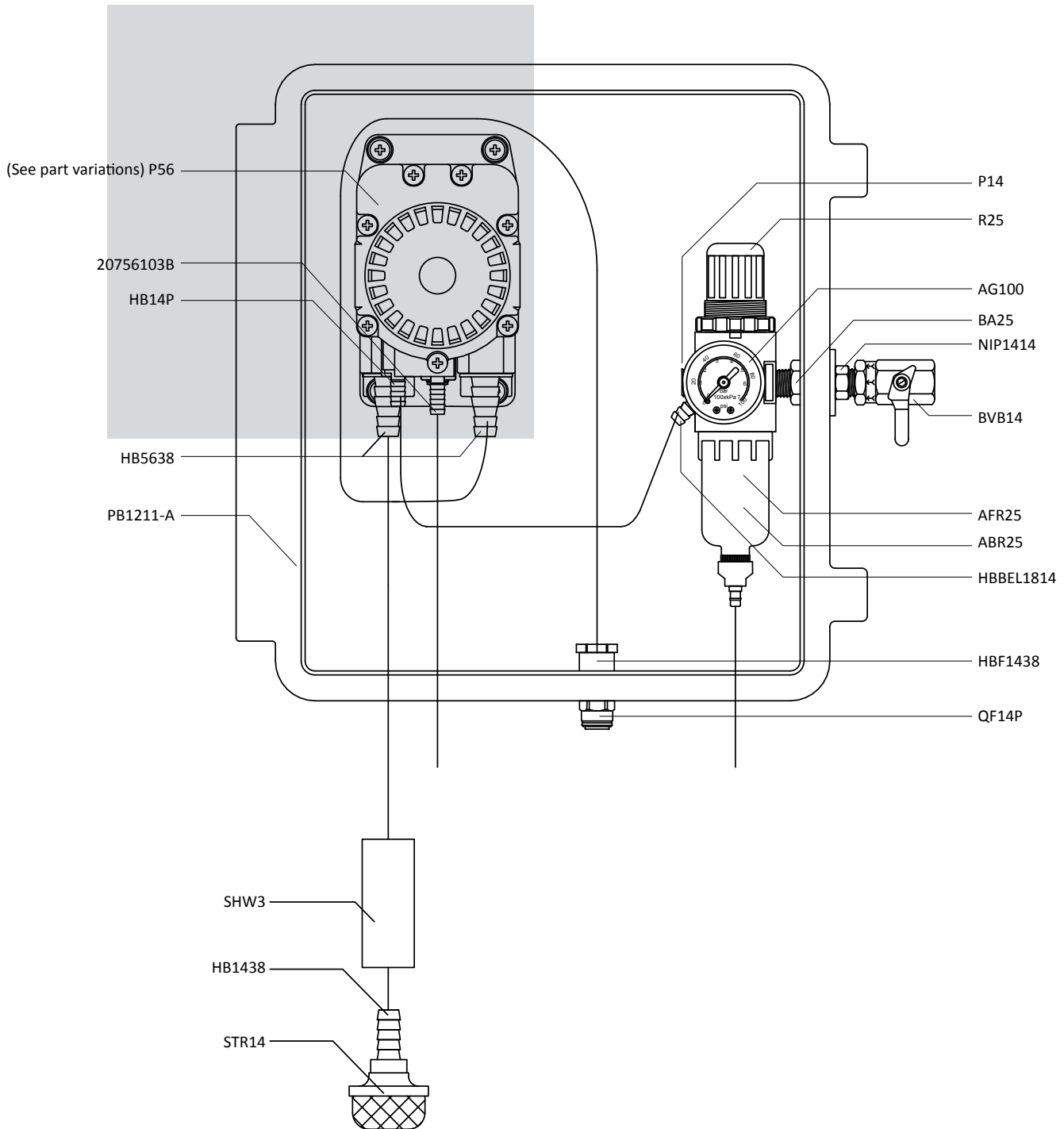

READ ALL INSTRUCTIONS BEFORE OPERATING EQUIPMENT

Part Variations:

Model: TS5600
Item Number: P56

Model: TS5600V
Item Number: P56V

Model: TS5600K
Item Number: P56K

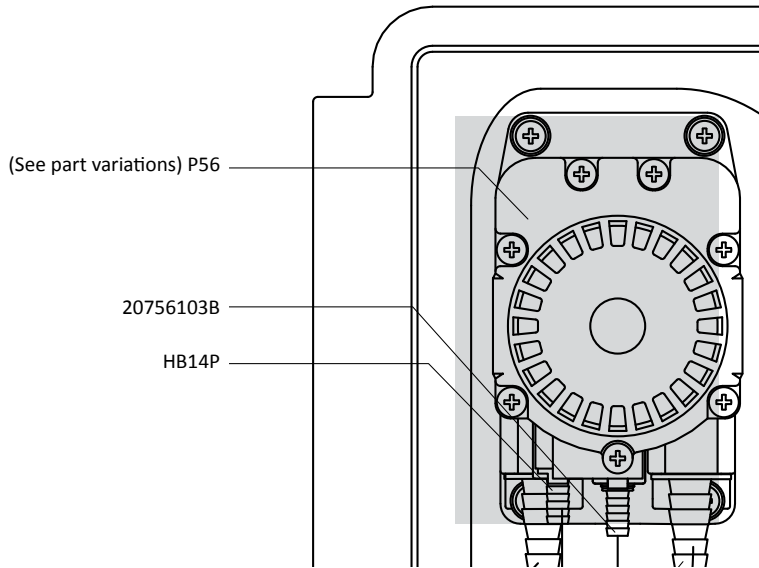

READ ALL INSTRUCTIONS BEFORE OPERATING EQUIPMENT

Parts List

ITEM NUMBER	DESCRIPTION
20756103B	Polypro G57 Air Port x HB Straight, w/ Viton o-ring
ABR25	METAL AIR BOWL for R25
AFR25	AIR FILTER for R25
AG100	1.5in DRY MODEL 20 DUAL SCALE GAUGE
AS1-P	1/4-20 X 1/2in SCREW WITH PATCH
B103278F	10-32 X 7/8 PHIL FLAT MACH SCR 18-8
BA25	MALE/FEMALE ADAPTER 1/4 X 1/4
BH142015	BUTTON HEAD SOCKET CAP - 1/4 - 20 x 1.5 STAINLESS STEEL
BKSS	BOX KEEPER STAINLESS STEEL
BLSS	Stainless Steel Latch
BVB14	VA BRS 025-4F4F-BT, NICKEL
EC14	OETIKER CLAMP 14.5-706RD
EC38	STEPLESS EAR CLAMP
FWLG14	.569 ID X 1.28 OD X .08 THICK FLAT WASHER SS 18-8
H14B	1/4in BLUE GENERAL SERVICE HOSE
H38B	3/8in BLUE GENERAL SERVICE HOSE
HB1438	1/4in MPT X 3/8in HOSE BARB (PLASTIC)
HB14P	1/4in BRASS HB AIR FITTING /G57/ P56
HB5638	HOSE BARB FOR P56 PUMP
HBB1438	BRASS 1/4 MPT X 3/8 HOSE BARB
HBBEL1814	1/8 MPT X 1/4 HOSE BARB BRASS 90DEG
HBF1438	1/4in FPT X 3/8in HOSE BARB - POLYPRO
NIP1414	1/4 BRASS NIPPLE
P14	COUNTERSUNK PLUG-HEXAGON 1/4
P56	FLOJET G57 PUMP WITH SANTO
P56K	FLOJET G57 PUMP WITH KALREZ
P56V	FLOJET G57 PUMP WITH VITON
PB1211	GRAY POLY BOX 12 X 11 X 6
PB1211-A	GRAY POLY BOX ASSEMBLY

PB1211-GSKT	3/32 INCH THICK GSKT WITH PSA
PBFT-SS	POLY BOX SS FOOT
PL1211	12X11 INCH POLYETHYLENE LID
QF14P	MALE CON. 1/4in TUBE X 1/4in MPT
QFA1414	1/4in TUBE X 1/4in HOSE STEM
QFSA1414	STEM ADAPTER 1/4in STEM X 1/4in NPT
R25	AIR REGULATOR - SILVER COLOR - 1/4fpt TWO PORT 1/8fpt TWO PORT
RIVSS-18-4	1/8 Stainless Rivet/Stainless Mandrel - Length .400 - Grip Range (.188 - .250)
SHW3	3in LONG COATED WEIGHT
SSC38	WORM GEAR CLAMP, S/S (.25-.63)
STR14	40 MESH SUCTION LINE STRAINER 1/4 MNPT
WMS14	14 X 1 1/4 HEX W/H SMS SLOTT, S/S
WMS14A	5/16 X 1 1/2 STRAIGHT PLASTIC ANCHOR

READ ALL INSTRUCTIONS BEFORE OPERATING EQUIPMENT

Safety Instructions:

1. Always wear safety goggles and protective gloves while operating unit.
2. Avoid contact of cleaning agent with skin and eyes.
3. If contact occurs, see MSDS sheet for further first aid measures.
4. After use, relieve all remaining pressure in the system by unplugging the air line from the unit and opening the valve until all pressure is released.
5. Never point the discharge at anyone.

Installation Instructions:

1. Read all instructions before installing the foam unit.
2. Remove all parts from box.
3. Select desired area to mount the control box. We recommend that the control box is mounted 6 feet or less from the floor.
4. Mount the control box using 4 of the screws provided. Note: When drilling holes for the plastic anchors provided with the screws, use a 5/16 inch drill bit.
5. Connect the intake hose to the pump inlet (HB5638).
6. Connect the outlet hose to the outlet fitting (QF14P). Additional adaptors (HBF1438/QFA1414/QFSA1414) may be used if needed.
7. Attach a 3/8inch I.D. air line from your air compressor to the hose barb on the outside of the control box. Note: The air compressor should be able to maintain at least 40 PSI at 4 CFM during operation of the foamer. We recommend at least a 3 HP compressor with a 12 gallon tank.

Operation Instructions:

1. Follow all instructions from chemical manufacturer. Fill the drum with pre-mixed solution.
2. Place the suction line in chemical solution. Note: make sure strainer can reach the bottom of the container.
3. With the discharge in the closed position, open air inlet valve (BVB14).
4. Slowly open discharge. **DO NOT POINT DISCHARGE AT ANYONE.**
5. Close air inlet valve (BVB14) and relieve any remaining pressure in the system after each use.

Maintenance:

To keep your unit operating properly, periodically perform the following maintenance procedures:

1. Check the air pump for wear and leaks.
2. Replace filter in regulator as needed.
3. Check the suction tube and screen for debris and clean as needed.
4. Drain compressor tank on a regular basis to ensure proper operation of pump.