USER MANUAL

**MODEL NUMBER:
FOG-IT6
NZA-PNZX1-WBRKT
NZA-PNZX1-WBRKT-WTB-26
AND RELATED ITEMS**

Wall-Mounted Fog System

English (Original Instructions)

READ ALL INSTRUCTIONS BEFORE OPERATING EQUIPMENT

WARNING



Read this manual completely and understand the machine before interacting with it.

- Read all instructions before installing or operating unit.
- Always wear appropriate personal protective equipment (PPE) when operating or servicing unit.
- Always follow all chemical safety precautions and handling instructions provided by the chemical manufacturer and Safety Data Sheet (SDS).
- Fogging with chemical products can be hazardous. Know the hazards of your chemical products prior to use. Wear appropriate personal protective equipment and follow all instructions and safety precautions in accordance with the SDS for your chemical product.
- If this unit is modified or serviced with parts not listed in this manual, the unit may not operate correctly.
- Before performing any maintenance on this unit, disconnect the unit from the electrical power source and compressed air supply, and open the air purge valve (QFSOV38) to release any air pressure stored in the system.
- Do not exceed an incoming air pressure of 150 psi (10.3 bar).
- Do not exceed a fluid temperature of 100°F (37.8°C).
- Only use clean and dry air. Air must be filtered and free of moisture or pump life will be diminished. If needed, install a water separator before unit.
- Do not use an air lubricator before the unit.
- Never use unit if it is damaged or leaking.
- Disconnect unit from electrical power source before servicing.

PROTECT THE ENVIRONMENT

Please dispose of packaging materials, old machine components, and hazardous fluids in an environmentally safe way according to local waste disposal regulations.



Always remember to recycle.

Specifications and parts are subject to change without notice.

| OPTIONS | |
|--|--------------------------------|
| Control box | Pump Seal Material |
| | Santoprene (<i>standard</i>) |
| | Viton (V) |
| FOG-IT6 | Kalrez (K) |
| Add bold option codes to item number as shown. For standard options, no option code is needed. Examples: <ul style="list-style-type: none"> • FOG-IT6 (standard unit with Santoprene pump seals) • FOG-IT6V (unit with Viton pump seals) | |
| Nozzle assemblies | NZA-PNZX1-WBRKT |
| | NZA-PNZX1-WBRKT-WTB-26 |

READ ALL INSTRUCTIONS BEFORE OPERATING EQUIPMENT

| REQUIREMENTS | | |
|-----------------------------|---|--|
| | WITH NZA-PNZX1-WBRKT NOZZLES: | WITH NZA-PNZX1-WBRKT-WTB-26 NOZZLES: |
| Compressed air requirements | At factory air pressure setting of 50 psi (3.4 bar): 2 cfm (56.6 l/min) for control box, plus 2.5 cfm (70.8 l/min) per nozzle Maximum incoming air pressure: 150 psi (10.3 bar) | At factory air pressure setting of 50 psi (3.4 bar): 2 cfm (56.6 l/min) for control box, plus 5 cfm (142 l/min) per nozzle Maximum incoming air pressure: 150 psi (10.3 bar) |
| Liquid temperature range | 40-100°F (4.4-37.8°C) | |
| Electrical requirements | 120 VAC at 60 Hz, 2 amps (GFCI protected outlet) | |
| Operating voltage | 120 VAC | |
| Chemical compatibility | Chemical products used with this equipment must be formulated for this type of application and compatible with unit materials and pump seals. For more information on chemical compatibility, consult the manufacturer or SDS for your product. | |

| SPECIFICATIONS | | |
|---------------------------------------|--|---|
| | WITH NZA-PNZX1-WBRKT NOZZLES: | WITH NZA-PNZX1-WBRKT-WTB-26 NOZZLES: |
| Power type | Compressed air, electricity | |
| Chemical pickup type | Draws from pre-mixed solution | |
| Number of products unit can draw from | One product | |
| Suction line length/diameter | 8 ft. (2.4 m) hose with 3/8 in. (9.5 mm) inside diameter) | |
| Flow rate* | 7.9 oz/min (0.23 l/min) per nozzle | 5.3 oz/min (0.16 l/min) per nozzle |
| Pump seals | Santoprene, Viton, or Kalrez | |
| Nozzle construction | Polypropylene and kynar | Celcon, stainless steel, EPDM and nylon |
| Timer operation type | Multifunction - delay on make single shot | |
| Droplet size | 15 micron at 50 psi (3.4 bar) | 35 micron at 50 psi (3.4 bar) |
| Coverage area | 1 liter of solution will cover approximately 1000 cubic feet** | |
| Coverage pattern | Flat pattern with projection up to 10 ft. (3 m) from nozzle | Pattern up to 8 ft. (2.4 m) wide (side to side) and 3 ft. (0.9 m) thick (top to bottom), with projection up to 15 ft. (4.6 m) from nozzle |
| Number of nozzles*** | 1-20 nozzles per control box | 1-12 nozzles per control box |
| Tubing/fitting sizes | Designed for use with 3/8 in. (9.5 mm) outside diameter tubing between control box and nozzle(s) | |

*Dilution rates and flow rates given are based on chemical with viscosity of water and factory air pressure settings.

**Area covered and run time may vary based on humidity, air flow, and product used.

***Number of nozzles is dependent upon air supply (see Compressed Air Requirements)

READ ALL INSTRUCTIONS BEFORE OPERATING EQUIPMENT

Installation Instructions

1. Remove all components from packaging.
2. Select an area to mount the control box.
Note: The control box should be mounted to a vertical wall. We recommend mounting the control box at a height of 6 ft. (1.8 m) or less. The chemical suction line must reach the bottom of the chemical container. The bottom of the chemical container should not be positioned higher than the bottom of the control box.
3. Attach the control box mounting feet to the back of the control box, using the four screws provided in the parts package.
4. Mount the control box to the wall using the four screws and plastic anchors provided in the parts package.
Note: To drill holes for the plastic anchors, use a $\frac{5}{16}$ inch drill bit.
5. Install the air purge valve and tee fitting as shown in the diagram below.

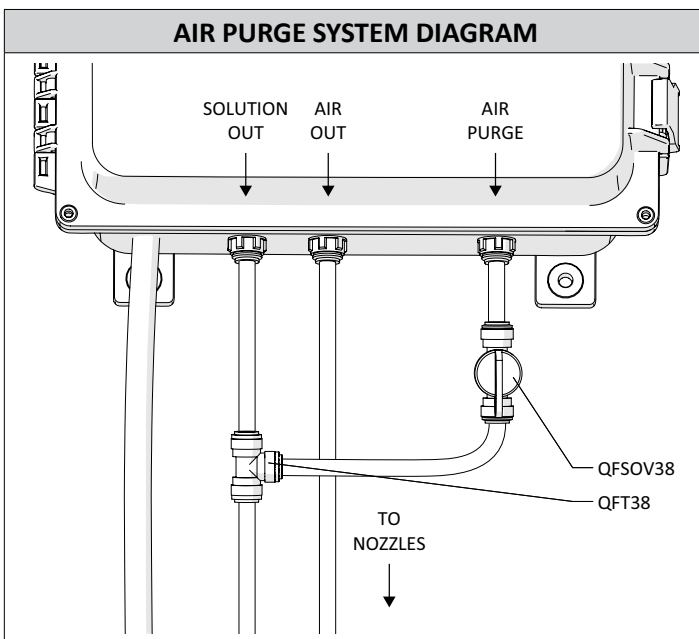

6. Mount the fog nozzle assembly in the desired location, using the included screws and plastic anchors. Repeat as needed for multiple nozzles.
7. Run tubing from the tee fitting to the solution inlet fitting on a nozzle assembly. Then run tubing from the solution outlet fitting on the original nozzle to the solution inlet fitting on the next nozzle. Repeat as needed for multiple nozzles.

8. Run tubing from the air outlet on the control box to the air inlet fitting on a nozzle assembly. Then run tubing from the air outlet fitting on the original nozzle to the air inlet fitting on the next nozzle. Repeat as needed for multiple nozzles.
Note: The air and solution lines must be routed to the appropriate fittings (as labeled), or the fog quality of the unit will be negatively impacted. Make sure to insert the tubing all the way into the fittings to ensure proper connection.
9. When you reach the last nozzle, either plug the air and solution outlet fittings, or loop the air and solution lines from the last nozzle back into the system.
Note: Depending on your configuration, plugs, additional tee fittings and/or additional tubing may be required to complete the installation.
10. With the air inlet valve in the closed position, connect a compressed air line to the air inlet fitting. The air inlet fitting is $\frac{1}{2}$ in. FPT.
11. Set the timer or the desired delay time and run time, as described in the timer adjustment instructions on **page 9**.
12. With the power switch in the OFF position, plug the unit into a GFCI protected 120 VAC power outlet.
13. Follow all instructions from chemical manufacturer. Place the chemical suction line into a container of pre-mixed chemical solution.

READ ALL INSTRUCTIONS BEFORE OPERATING EQUIPMENT

Operation Instructions

Fogging with chemical products can be hazardous. Know the hazards of your chemical products prior to use. Wear appropriate personal protective equipment and follow all instructions and safety precautions in accordance with the SDS for your chemical product.

1. Prepare the area to be fogged.
2. Verify the delay time and run time settings on the timer (see Timer Adjustment Instructions.)
3. Make sure the air inlet valve is open, and the air purge valve is closed.
4. Turn the power switch to the ON position.
5. To activate the unit, push the green button. The unit will begin cycling through the delay and run time intervals set on the timer, beginning with the delay time.
6. At the end of the run time, the unit will shut off. Observe appropriate safety precautions when reentering the area, in accordance with the MSDS for your chemical product.
7. Turn the power switch OFF to prevent unwanted activation of the unit
8. With the air inlet valve in the open position, open the air purge valve to clear any solution from the lines. Close the air purge valve after all solution has been cleared from the system.

Maintenance Instructions

To keep your fog unit operating properly, periodically perform the following maintenance procedures:

Note: Before performing any maintenance, disconnect the unit from the electrical power source and compressed air supply, and open the air purge valve to release any air pressure stored in the system.

- Inspect the pump for wear and leaks.
- Inspect all hoses for leaks or excessive wear. Make sure all hose clamps and push-fittings are in good condition and properly secured.
- Check the chemical suction line and strainer for debris and clean as needed.
- Drain your air compressor tank on a regular basis to help extend pump life. An air source with a high moisture content will accelerate pump wear. **Note:** If your air source has a high moisture content, you may wish to install a water separator before the unit.

Troubleshooting Instructions

- If air passes through the pump without cycling, the pump needs to be replaced.
- Check the chemical suction line and strainer for debris or damage. Clean or replace as needed. To prevent damage to the unit, the strainer must always be used.

READ ALL INSTRUCTIONS BEFORE OPERATING EQUIPMENT

**CONTROL BOX ASSEMBLY
Inside View**

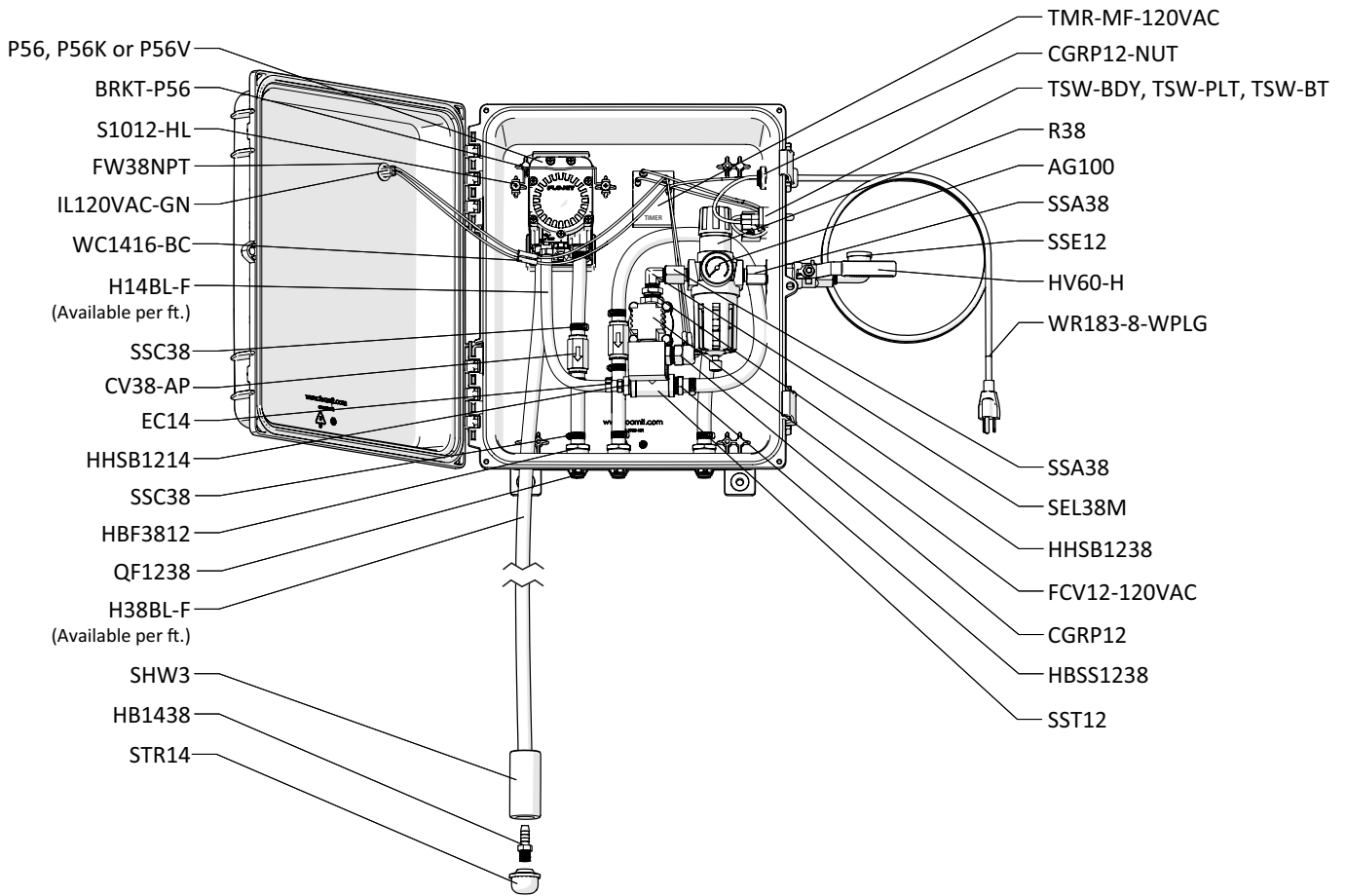

**CONTROL BOX ASSEMBLY
Outside View**

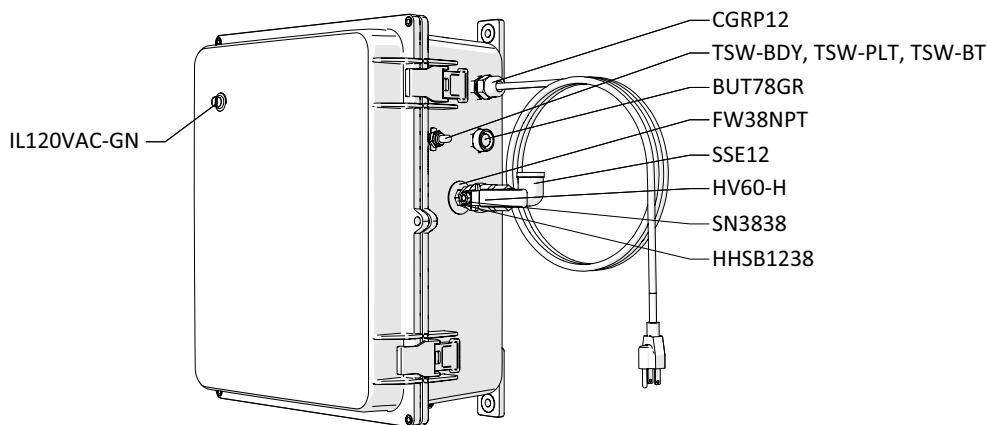

OPTIONAL COMPONENT

WATER SEPARATOR ASSEMBLY
Item Number: WSA-20CFM

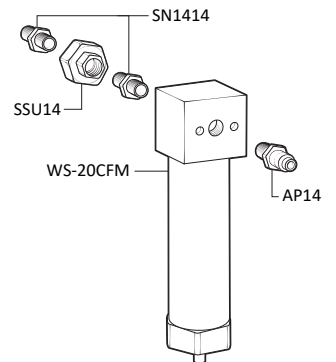

READ ALL INSTRUCTIONS BEFORE OPERATING EQUIPMENT

NOZZLE ASSEMBLY Item Number: FG-NA-N130

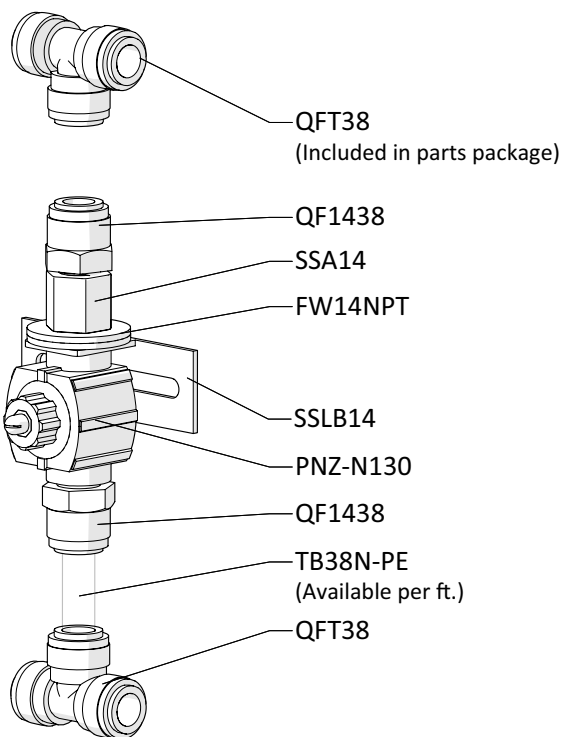

NOZZLE ASSEMBLY Item Number: FG-NA-26SS or FOG-IT6-NP

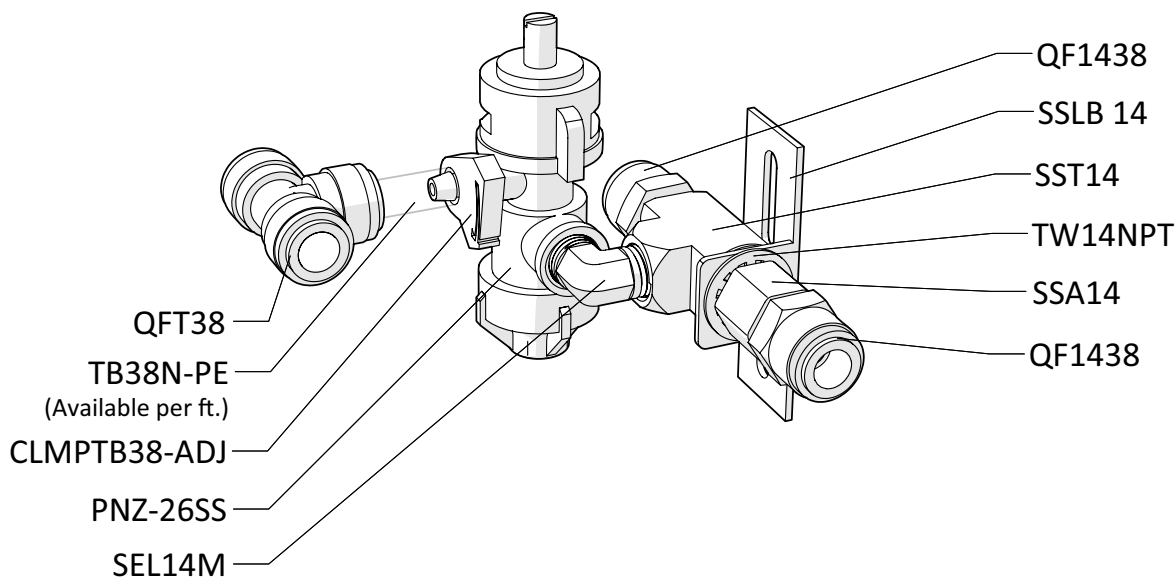

READ ALL INSTRUCTIONS BEFORE OPERATING EQUIPMENT

| ITEM NUMBER | DESCRIPTION |
|--------------|--|
| AG100 | AIR GAUGE - 1/8IN NPT - 0-100 PSI MARKINGS - DRY MODEL |
| B103214 | BOLT - 10-32 X 1/4IN - STAINLESS STEEL - TRUSS HEAD PHILLIPS |
| BRKT-P56 | PUMP BRACKET- STAINLESS STEEL |
| BUT78GR | PUSH BUTTON - FLUSH GREEN CAP - NORMALLY OPEN |
| CB-5 | CIRCUIT BREAKER ASSEMBLY - 5 AMP - INCLUDES CLEAR BOOT |
| CB-BT | CLEAR BOOT FOR CIRCUIT BREAKER |
| CGRP12 | CORD GRIP - 1/2IN MPT - BLACK NYLON - CORD RANGE 0.17IN TO 0.45IN - WATER RESISTANT - FOR 7/8IN HOLE - NO NUT INCLUDED |
| CGRP12-NUT | NUT - 1/2NPT - BLACK NYLON |
| CLMPTB38-ADJ | CLAMP FOR 1/4 IN OD TUBE - PLASTIC - ADJUSTABLE |
| CV38-AP | CHECK VALVE-3/8IN BARBS-PVC BODY-HASTELLOY SPRING-TEFLON BALL-WHITE |
| EC14 | EAR CLAMP - OETIKER - STAINLESS STEEL - FOR 1/4IN HOSE |
| FCV12-120VAC | 1/2 NPT AIR SOLENOID - 120V - 31GPM - BRASS |
| FW38NPT | FLAT WASHER FOR 3/8IN NPT - STAINLESS - 0.69IN ID X 1.5IN OD X 0.07IN THK |
| FW14NPT | FLAT WASHER FOR 1/4 IN. NPT - STAINLESS - 0.57 IN. ID X 1.28 IN. OD X 0.08 IN. THK |
| H14BL-F | 1/4IN BLUE HOSE-HYBRID TPE-AVAILABLE PER FT |
| H316CL-PV | 3/16IN ID 5/16IN OD CLEAR HOSE - PVC - AVAILABLE PER FT |
| H38BL-F | 3/8IN ID BLUE HOSE-HYBRID TPE-AVAILABLE PER FT |
| HB1438 | 1/4in MPT X 3/8in HOSE BARB (PLASTIC) |
| HBSS1414 | HOSE BARB - STAINLESS STEEL - 1/4IN MPT X 1/4IN BARB |
| HBF1238 | HOSE BARB - POLYPROPYLENE - 1/2IN FPT X 3/8IN BARB |
| HBSS1238 | HOSE BARB - STAINLESS STEEL - 1/2IN MPT X 3/8IN BARB |
| HBSS1438 | HOSE BARB - STAINLESS STEEL - ELBOW - 1/4IN MPT X 3/8IN BARB |
| HHSB1418 | HEX HEAD STAINLESS BUSHING 1/4 MPT X 1/8 FPT |
| HHSB1238 | HEX HEAD STAINLESS BUSHING 1/2 MPT X 3/8 FPT |
| HHSB1238 | HEX HEAD S.S. REDUCER BUSHING 1/2in X 3/8 |
| HV60-H | 1/2IN STAINLESS BALL VALVE - STRAIGHT HANDLE - NO WELDED NUT |
| IL120VAC-GN | INDICATOR LIGHT - 120VAC - GREEN - PANEL MOUNT - 6IN WIRE LEADS |
| P56 | PUMP WITH SANTOPRENE SEALS - INCLUDES HOSE BARBS, AIR FITTING, AND EXHAUST BARB |
| P56K | PUMP WITH KALREZ SEALS - INCLUDES HOSE BARBS, AIR FITTING, AND EXHAUST BARB |
| P56V | PUMP WITH VITON SEALS - INCLUDES HOSE BARBS, AIR FITTING, AND EXHAUST BARB |
| HBB14P | 1/4IN HOSE BARB-BRASS-FOR G57/P56 AIR FITTING WITH O-RING |
| HB5638 | HOSE BARB FOR P56 PUMP |
| HB5638K | HOSE BARB FOR P56K PUMP |
| HB5638V | HOSE BARB FOR P56V PUMP |
| PBA-16138 | POLY BOX ASSEMBLY - 16IN X 13IN X 8IN - GRAY POLYPROPYLENE - INCLUDES BRAND LABEL AND MOUNTING HARDWARE |
| PB16138-LID | POLY BOX LID - GRAY POLYPROPYLENE - FOR PBA-16138 - INCLUDES PB-GSKT ROPE SEAL |
| PB16138-BOX | POLY BOX - GRAY POLYPROPYLENE - FOR PBA-16138 |

| | |
|-----------------|---|
| PB-FT | POLY BOX FOOT - GRAY POLYPROPYLENE - FOR PBA-12117 AND PBA-16138 |
| PB-LTCH | POLY BOX LATCH - GRAY POLYPROPYLENE - TWO PIECES ASSEMBLED - FOR PBA-12117 AND PBA-16138 |
| PB-PIN | STAINLESS STEEL HINGE PIN FOR PB16138 AND PB12117 |
| PNZ-26SS | PNEUMATIC MIXING NOZZLE - NYLON BODY - STAINLESS STEEL TIP - 2.5 GAL/HR |
| PNZ-N130 | PNEUMATIC MIXING NOZZLE - POLYPROPYLENE BODY - BLUE KYNAR TIP - 3.7 GAL/HR |
| QF1238 | QUICK FIT-1/2 MPT X 3/8 OD TUBE-POLYPROPYLENE |
| QF1438 | MALE CON. 3/8in TUBE X 1/4in MPT - POLYPROPYLENE |
| QF50V38 | SHUT OFF VALVE 3/8in TUBE POLYPROPYLENE |
| QFT38 | UNION TEE 3/8in TUBE POLYPROPYLENE |
| R38 | REGULATOR - AIR - 2X 1/4IN FPT AND 2X 3/8IN FPT PORTS - NO GAUGE |
| S1012-HL | SCREW - #10 X 1/2IN - STAINLESS STEEL - ROUND HEAD PHILLIPS - HILO THREAD |
| S1034-FH-HL | SCREW - #10 X 3/4IN - STAINLESS STEEL - FLAT HEAD PHILLIPS - HILO THREAD |
| SEL38M | STAINLESS ELBOW 3/8IN MPT X 3/8IN MPT |
| SHW3 | SUCTION HOSE WEIGHT - 15/16IN ID X 1 1/2IN OD X 3 1/4IN LONG - PVC COATED STAINLESS |
| SN1212 | STAINLESS HEX NIPPLE 1/2 MPT X 1/2 MPT |
| SN3838 | STAINLESS HEX NIPPLE 3/8 MPT X 3/8 MPT |
| SSA14 | SS304 MALE/FEMALE ADAPTOR 1/4 NPT X 1/4 NPT |
| SSA38 | STAINLESS ADAPTOR 3/8 MPT X 3/8 FPT |
| SSC38 | STAINLESS SCREW BAND CLAMP FOR 3/8 IN HOSE |
| SSE12 | STREET ELBOW 1/2in - 316 S.S. |
| BRKT-EL-14 | 14GA SS BRACKETS W/SLOTS |
| SST12 | BRACKET - L-SHAPED MOUNTING - FOR 14NPT FITTINGS - STAINLESS STEEL |
| STR14 | 40 MESH SUCTION LINE STRAINER 1/4 FNPT |
| TB38N-PE | 3/8IN OD NATURAL TUBE - POLYETHYLENE - AVAILABLE PER FT |
| TMR-MF-120VAC | TIMER - MULTI-FUNCTION RELAY - 0.05SEC TO 10230HR ADJUSTABLE DIGI-SET - 120VAC - 10A MAX - USES 11 PIN SOCKET |
| TMR-SCKT-DIN-11 | TIMER SOCKET - FOR DIN RAIL MOUNTING - 11 PIN |
| TSW-BDY | TOGGLE SWITCH - BODY - SINGLE POLE SINGLE THROW - NICKEL-PLATED BRASS - 1/4IN SPADE TERMINALS - 1/2IN MOUNTING HOLE - 15/32-32 KEYED THREADED BUSHING |
| TSW-PLT | TOGGLE SWITCH - ON/OFF PLATE - NICKEL-PLATED STEEL - MOUNTING HOLE FOR 15/32 KEYED BUSHING |
| TSW-BT | TOGGLE SWITCH - MOUNTING BOOT - BLACK SILICONE RUBBER - 15/32-32 INTEGRATED NUT |
| TW14NPT | TOOTH LOCK WASHER FOR 1/4IN NPT - STAINLESS - 0.56IN ID X 0.96IN OD X 0.06IN THK |
| WMS14 | WALL MOUNT SCREW - #14 X 1 1/4IN - STAINLESS STEEL - HEX HEAD SLOTTED |
| WMS14A | WALL MOUNT SCREW ANCHOR -#14 X 1 1/4IN - PLASTIC - 5/16IN DRILL SIZE |
| WR183-8-WPLG | WIRE CORD WITH US STANDARD UNPOLARIZED GROUNDED PLUG - 18AWG 3 CONDUCTOR - 8FT LONG - BLACK RUBBER JACKET - EPDM INSULATION - TYPE SJOOW - 10A RATING |
| WSA-20CFM | WATER SEPARATOR ASSEMBLY-20CFM-1/4IN FPT PORTS-INCLUDES AIR PLUG, UNION FITTINGS |